

IXP- 3W4515/4W4515

Dust/
Splash-
proof
specification

Arm
length
450mm

Vertical
axis
150mm

■Model Specification Items	IXP	<div></div>	W	45	15	—	WA	—	<div></div>	—	P3
	Series	Number of axes	Type	Arm length	Vertical axis stroke	—	Encoder type	—	Cable length	—	Applicable controller
		3: 3 axes 4: 4 axes	W: Dust/ Splash-proof specification	45: 450mm	15: 150mm		WA: Battery-less absolute specification		3L: 3m 5L: 5m Cable length described below Refer to the price list.		P3: MSEL

*Controller is not included.



*The photograph shows a 4-axis specification.



- Refer to P. 7 for *1 through *8.
- The vertical axis has no brake. The unique structure holds the load in place even when the servo is turned off.
- The vertical axis does not support push-motion control.
- The allowable push force is 60N under condition of having a buffer such as a spring on a tool or the pressing side.
- Refer to P. 7 for the work envelope, and P. 8 for the notes on acceleration/deceleration setting.

Robot Specifications

Axis configuration		Arm length (mm)	Work envelope	Positioning repeatability *1	Maximum operating speed in PTP mode *2	Payload (kg) *3	
						Rated	Maximum
Axis 1	Arm 1	260	±127°	±0.03mm	2194mm/s (Composite speed)	1	3
Axis 2	Arm 2	190	±127°				
Axis 3	Vertical axis	—	150mm	±0.02mm	270mm/s		
Axis 4	Rotational axis	—	±360°	±0.02°	1000°/s		

Robot Specifications

	3-axis specification	4-axis specification
Encoder type	Battery-less absolute encoder	
Standard cycle time *4 (sec)	0.74	
Allowable torque (Axis 4) (N·m)	—	1.4
Allowable moment (N·m)	2.9	
Allowable inertial moment from the tip of the vertical axis *5 (kg·m ²)	Rated 0.003 Maximum 0.01	Rated 0.003 Maximum 0.003
Ambient operating temperature/humidity	Temperature 0 ~ 40°C Humidity 20 ~ 85%RH (Non-condensing)	
Unit weight (kg)	18	19
Protection class	IP65	
Piping joint for purge	One touch piping joint Applicable tube O.D. ø6	
Air purge pressure *8	1kPa (Clean dry air)	
Purge flow rate	12Nℓ/min	

Price List (Standard price)

Specification	Model number	Standard price
3-axis specification	IXP-3W4515	—
4-axis specification	IXP-4W4515	—

Cable Length (Standard price) <Per Unit>

Cable code	Standard price
3L (3m)	—
5L (5m)	—

Dimensions



CAD drawings can be downloaded from the website.

www.intelligentactuator.com

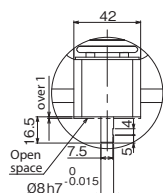

Detailed view of A

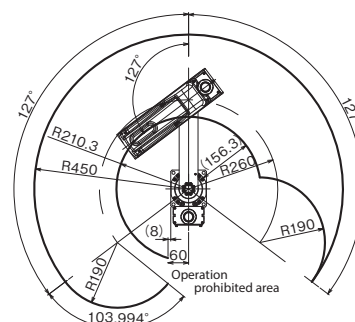
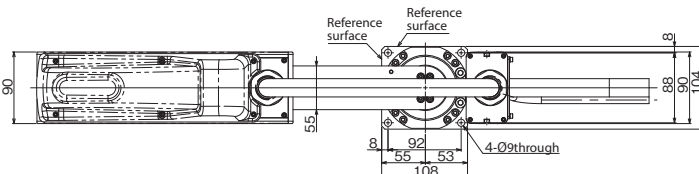

Work envelope of the right-arm system

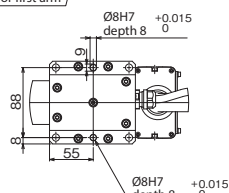
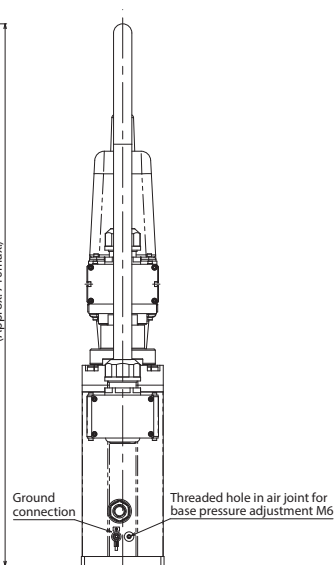
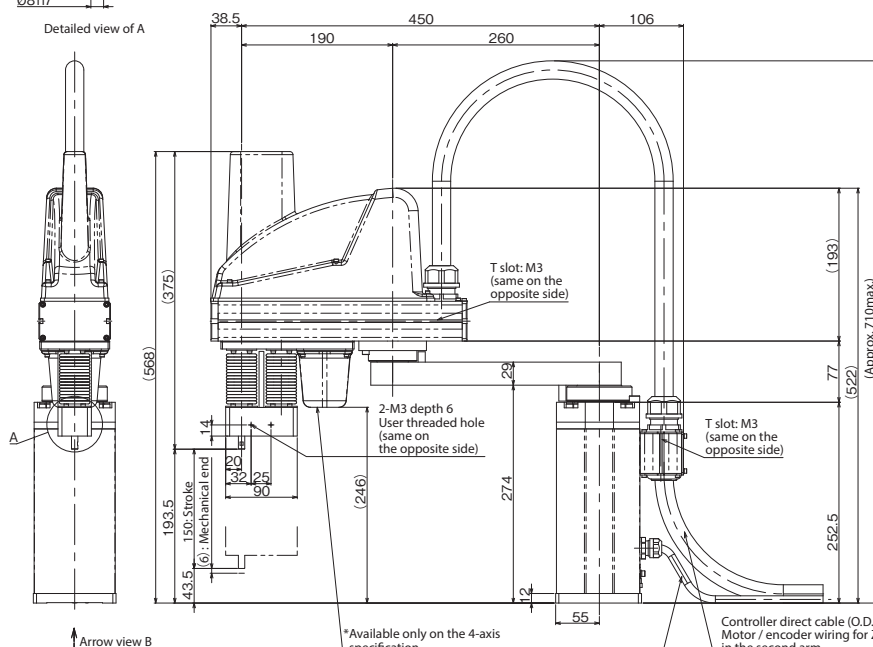



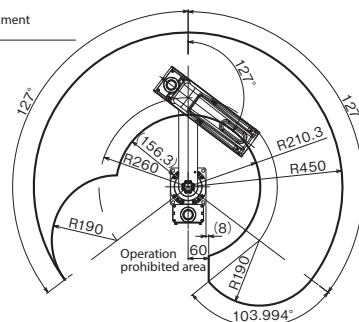

Detailed view on arrow of B



Work envelope of the left-arm system

Applicable Controller

IXP series robots can operate with the following controllers. Make sure to select the model depending on the purpose.

Name	External view	Maximum number of controlled axes	Supply voltage	Control method				Max. pos. points	Standard price	Reference page
				Position	Pulse train	Program	Network *Option			
MSEL-PCX/PGX		4	Single-phase 100V ~ 230V	—	—	•	<div>   </div> <div>   </div>	30000	—	→P37