

IX-UNN3515[H]

Small SCARA robot, Wall-mount inverse type
Arm length 350mm, Vertical axis 150mm [High-power specification]



■Model items **IX** — ☐NN3515[H] — ☐ — **T2**

Series	Type	Cable length	Applicable controller
TNN3515[H]	Wall-mount type	5L : 5 m (standard)	T2: XSEL-PX/QX
	Arm length 350mm, Vertical axis 150mm	10L: 10 m	
UNN3515[H]	Wall-mount inverse type		
	Arm length 350mm, Vertical axis 150mm		



*For details on the model items, refer to page 8.

Model/Specifications

Model	Axis configuration		Arm length (mm)	Motor capacity (W)	Work envelope	Positioning Repeatability (mm) (Note 1)	PTP operation Maximum operating speed (Note 2)	Standard cycle time (sec) (Note 3)	Load capacity (kg) (Note 4)		Axis 3 (vertical axis) push force (N) (Note 5)		Axis 4 allowable load	
									Rated	Maximum	Maximum limit	Minimum limit	Allowable inertial moment (kg·m ²) (Note 6)	Allowable torque (N · m)
IX-TNN3515[H]-  -T2 IX-UNN3515[H]-  -T2	Axis 1	Arm 1	225	200	±120°	±0.010 (XY)	3979mm/s [4042mm/s] (Composite speed)	0.53 [0.42]	1	3	90.9 [111.0]	47.5 [58.0]	0.015	1.9
	Axis 2	Arm 2	125	100	±130°		1106mm/s [1316mm/s]							
	Axis 3	Vertical axis	-	100	150mm	±0.010	1600°/s							
	Axis 4	Rotating axis	-	50	±360°	±0.005								

*SCARA robots cannot operate continuously at 100% speed and acceleration.
For details on the operating conditions, refer to Reference Acceleration/
Deceleration Settings on page 44.

Common Specifications

Encoder type	Absolute
User wiring	15-conductor AWG26 D-sub/15-pin connector with shield (socket)
User tubing	Air tube (O.D. ø4, I.D. ø2.5) x 3 (Normal working pressure 0.8 MPa)
Alarm indicator (Note 7)	Small red LED indicator x 1 (24 V DC must be supplied.)
Brake-release switch (Note 8)	Allows remote release of Z-axis (24 VDC required)

Ambient temperature/humidity	Temperature: 0–40 °C, humidity: 20–85%RH or less (no condensation)
Unit weight	21.9Kg
Applicable controller	T2: XSEL-PX/QX
Cable length (Note 9)	5L: 5 m (standard), 10L: 10 m (optional)

Dimensions

*For the inverse type, the following illustrations should be turned upside down.
(See page 2.)

The CAD drawings can be downloaded from our Web site.

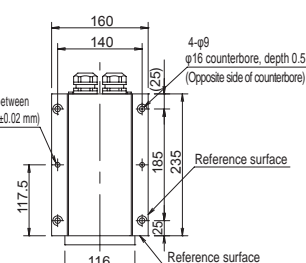
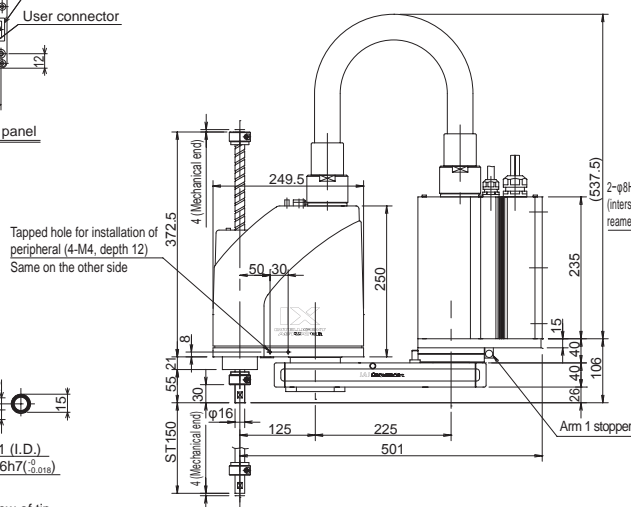
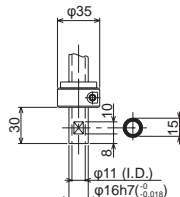
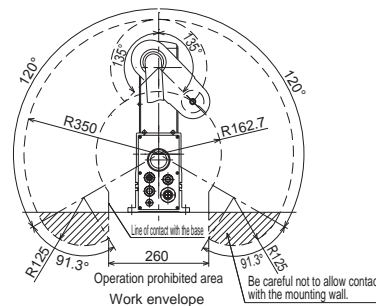
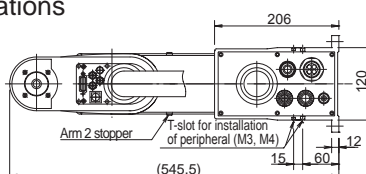
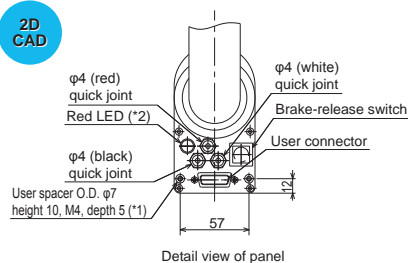

*1: The external force applied to a spacer must not exceed 30 N in the axial direction, or 2 N·m in the rotating direction. (for each spacer)

*2: In order to use the LED, the user must wire it so that it responds to the controller's I/O output signal by supplying 24 V DC to the applicable LED terminal in the user wiring.

Cables/tubes	
▪ Motor/encoder cable	5m/10m
▪ Brake power cable	5m/10m
▪ User Wiring Cable	5m/10m
▪ Air tube (4 pcs)	0.15m

Applicable Controller Specifications

Applicable Controller	Features	Maximum I/O points (inputs/outputs)	Power-supply voltage	Reference page
XSEL-PX-###-2[3]	Maximum 6 axes, 1600 [2400] W supported	192/192 points	Single-phase [Three-phase]	p. 37
XSEL-QX-###-2[3]	Safety Category 4 supported		230 VAC	

*The SCARA model with high-power specification [H] needs a 2.4 kW three-phase type controller XSEL-PX/QX-###-3.



For explanations of (Note 1) through (Note 9), refer to page 7.